

# INDUSTRIAL RENTAL EQUIPMENT

Providing the most reliable rental equipment with a huge fleet of inventory for midstream construction & repairs.



# MIDSTREAM CATALOG



Reducing cost without  
compromising on safety.  
That's the mark of Tiger.

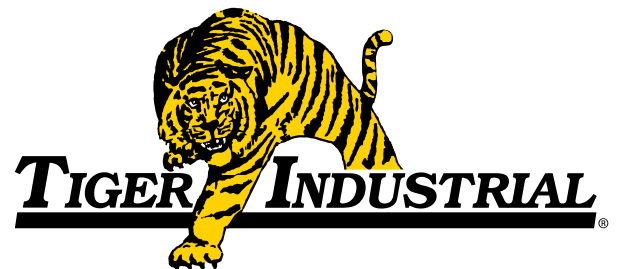

# MATS

Tiger has the matting solutions to make your project a success. Each mat has distinct individual advantages to fit your specific needs. Our combined fleet of mats encompasses solutions for integrity, pipeline, access roads, tank farms, refineries, high lines, train derailments, commercial construction, frac sand, completions sites, and many others.

At Tiger, we have an agnostic approach to mat rentals, we believe in all of them and have a mat for every application. Our highly skilled team can offer assistance in selecting the right mat for the right job, but if you have a preference for a specific mat, tell us what you want and we will get it to you - ASAP.



	ECOMATS™	TIGER POLY MATS	TIGER TIMBER MATS
<b>ADVANTAGES</b>	<ul style="list-style-type: none"> <li>• Maximum Durability</li> <li>• Extreme Life</li> <li>• Very Contractor Friendly</li> <li>• Fast &amp; Easy to Lay</li> <li>• Traceable with RFID Chip</li> <li>• High PSI</li> <li>• No Nails &amp; No Cable Loops</li> <li>• No Pinning Required</li> <li>• Flame Spread Rated</li> <li>• No Absorption and Won't Float</li> <li>• Repairable</li> </ul>	<ul style="list-style-type: none"> <li>• Long Life</li> <li>• No Nails</li> <li>• No Gaps</li> <li>• No Absorption</li> <li>• High PSI</li> <li>• Great when Combined with Good Sub Base</li> <li>• Ships in Containers</li> <li>• Great for a Sand Surface</li> </ul>	<ul style="list-style-type: none"> <li>• Made of Dense Mixed Hardwood with Lifting Rod</li> <li>• Each Rod is Notched for Safety and Security</li> <li>• Allows Heavy Equipment to Cross</li> <li>• Various Sizes Including Custom Sizing Available</li> </ul>
<b>SIZE</b>	8' x 16'	6.5' x 13'4"	4' x 18'
<b>SQ FT</b>	128 sq ft	86 sq ft	72 sq ft
<b>WEIGHT</b>	3,000 lbs	1,095 lbs	2,900 lbs
<b>MATS/TRUCK</b>	14-15	40	14-15
<b>CONNECTING</b>	Directly	8 Pin	Directly
<b>PSI</b>	3,910	600	N/A
<b>LINEAR FT/TRUCK</b>	112	260	56
<b>CONSTRUCTION</b>	HDPE+	HDPE+	Mixed Hardwood
<b>THICKNESS</b>	4"	4"	8"





# PUMPS



## TIGER DELIVERS OUR READY LINE IS UP AND READY

We keep a large fleet of pumps prepped for immediate deployment. Every piece of equipment we offer is put through a rigorous maintenance regimen to ensure the highest quality and performance.

Our knowledgeable personnel will help you select the right pump for the job, and we're available around the clock to offer any support you may need.

### PUMPS:

- Centrifugal
- Trash
- Water Transfer
- Vac Assist
- Air-Operated
- Diesel & Electric



### 6" X 6" VAC ASSIST PUMP (6612T)

<b>Horsepower</b>	74 HP
<b>Fuel Tank Capacity</b>	96 GAL
<b>Max Flow</b>	2750 GPM @ 75' TDH / 33 PSI
<b>Max TDH</b>	190' TDH/82 PSI @ 1000 GPM
<b>BEP</b>	2100 GPM @ 115' TDH/50 PSI

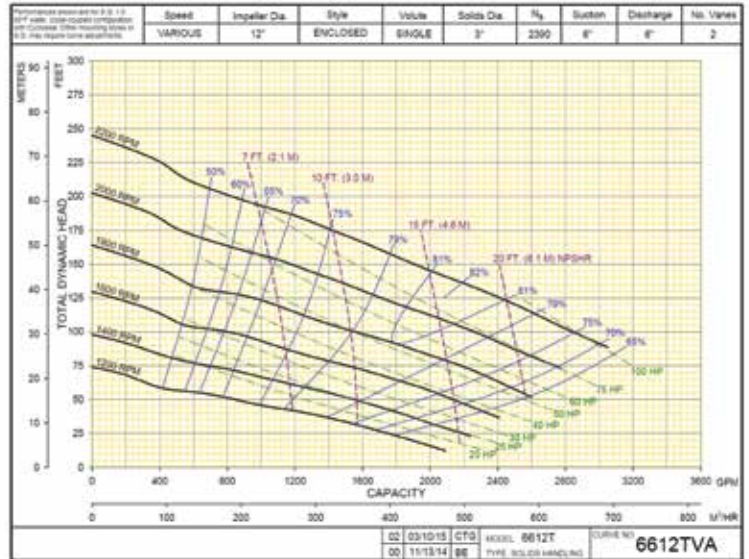

### 6" X 6" VAC ASSIST PUMP (6NNT)

<b>Horsepower</b>	74 HP
<b>Fuel Tank Capacity</b>	96 GAL
<b>Max Flow</b>	2800 GPM @ 52' TDH/23 PSI
<b>Max TDH</b>	140' TDH/60 PSI @ 250 GPM
<b>BEP</b>	1900 GPM @ 85' TDH / 37 PSI

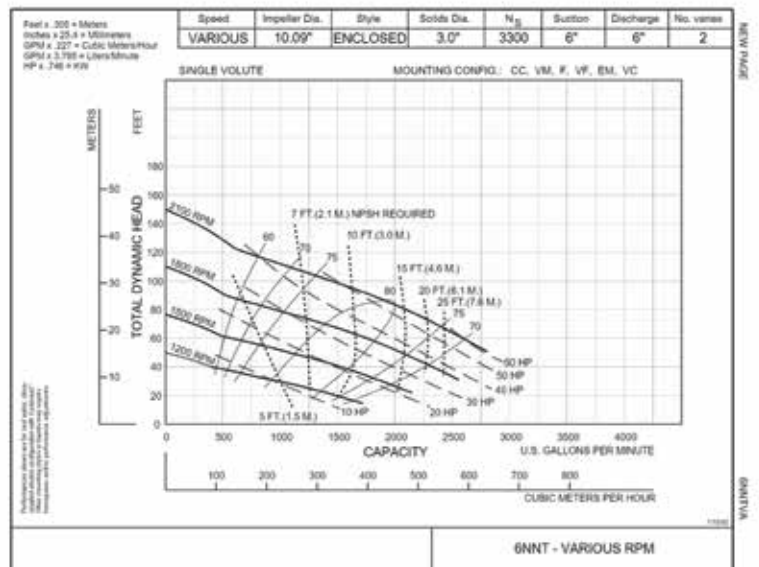



## 4" X 4" VAC ASSIST PUMP (4NNT)

<b>Horsepower</b>	49 HP
<b>Fuel Tank Capacity</b>	96 GAL
<b>Max Flow</b>	1340 GPM @ 46' TDH/20 PSI
<b>Max TDH</b>	120' TDH/52 PSI @100 GPM
<b>BEP</b>	840 GPM @ 82' TDH / 35 PSI

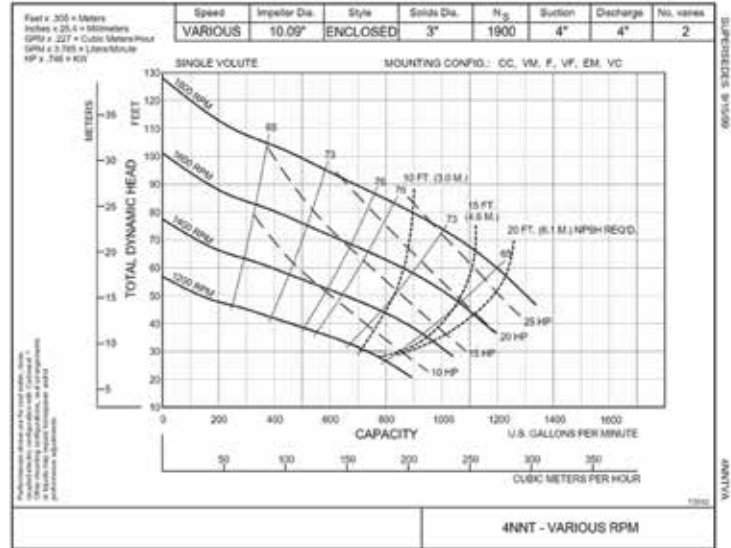

[ PUMPS ]

## SUPER 6 PUMP (6NHTA)

<b>Horsepower</b>	125 HP
<b>Fuel Tank Capacity</b>	96 GAL
<b>Max Flow</b>	2900 GPM @ 145' TDH / 63 PSI
<b>Max TDH</b>	285' TDH/124 PSI @ 250 GPM
<b>BEP</b>	2500 GPM @ 170' TDH/74 PSI

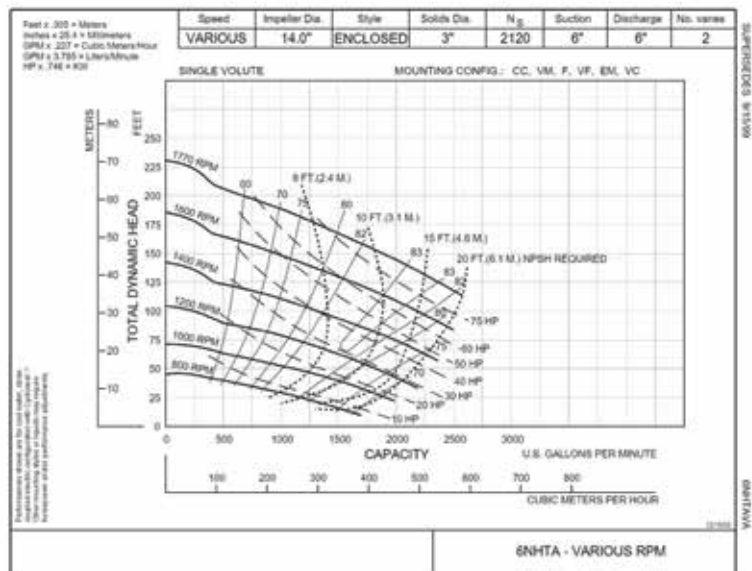







### SUPER 6" X 3" VAC ASSIST PUMP (3617MX)

<b>Horsepower</b>	174 HP
<b>Fuel Tank Capacity</b>	96 GAL
<b>Max Flow</b>	1200 GPM @ 380' TDH / 165 PSI
<b>Max TDH</b>	550' TDH/238 PSI @ 100 GPM
<b>BEP</b>	1000 GPM @ 400' TDH/173 PSI

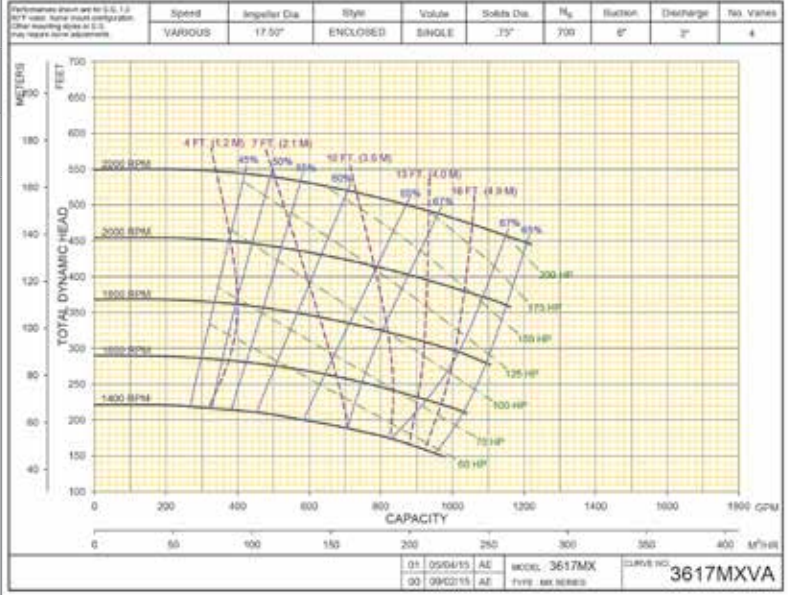

### 6" X 4" HIGH HEAD VAC ASSIST PUMP (4622MX)

<b>Horsepower</b>	325 HP
<b>Fuel Tank Capacity</b>	250 GAL
<b>Max Flow</b>	1650 GPM @ 460' TDH / 200 PSI
<b>Max TDH</b>	625' TDH/270 PSI @ 200 GPM
<b>BEP</b>	N/A

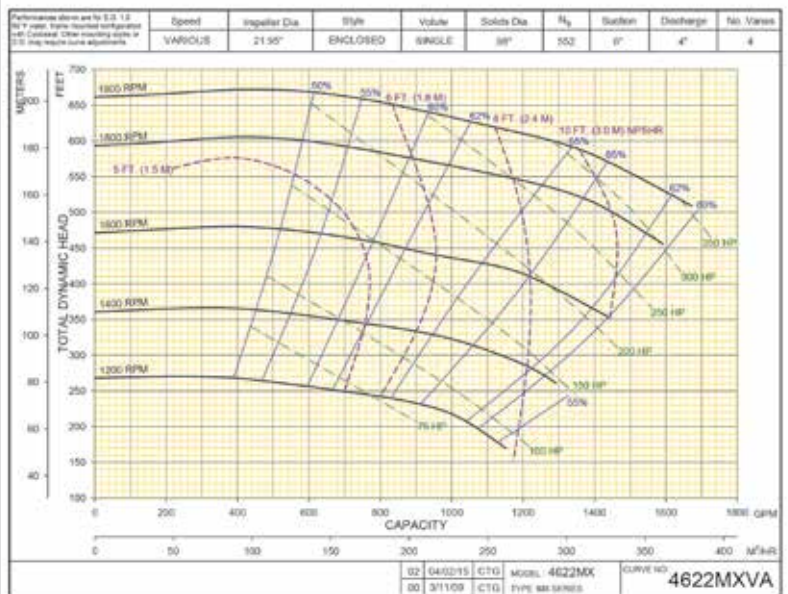

[ PUMPS ]



## 325 HP MEDIUM HEAD 10" X 8" PUMP (8NHTA)

Horsepower	325 HP
Fuel Tank Capacity	160 GAL
Max Flow	5100 GPM @ 150' TDH/65 PSI
Max TDH	350' TDH/152 PSI @ 500 GPM
BEP	3900 GPM @ 240' TDH/104 PSI

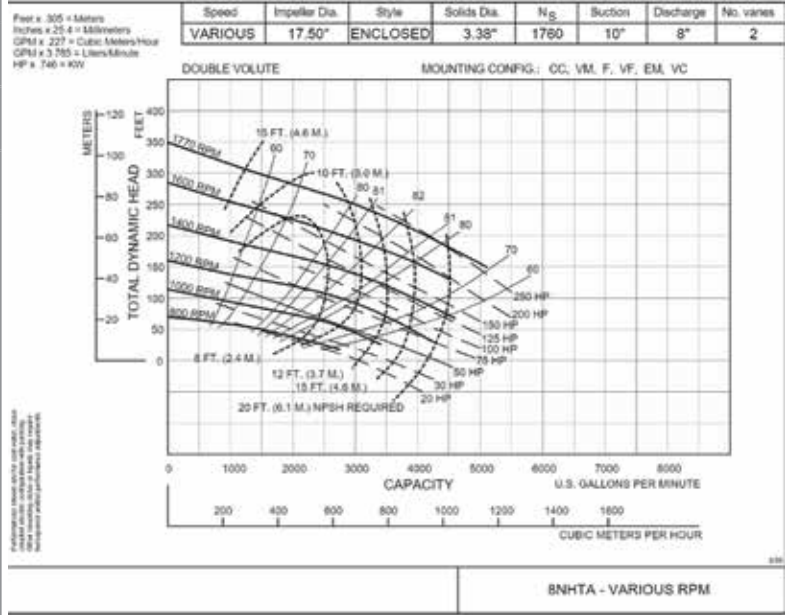

[ PUMPS ]

## 600 HP HIGH HEAD 10" X 8" PUMP (8NHTH)

Horsepower	600 HP
Fuel Tank Capacity	180 GAL
Max Flow	8100 GPM @ 225' TDH/97 PSI
Max TDH	425' TDH/184 PSI @ 500 GPM
BEP	5700 GPM @ 325' TDH/140 PSI

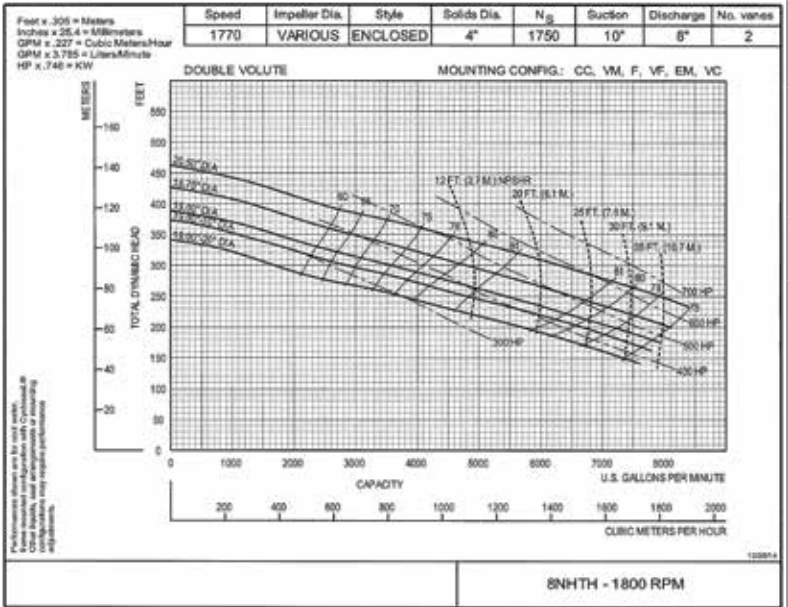



### 8" X 6" X 14" CENTRIFUGAL DIESEL PUMP

<b>Horsepower</b>	174 HP
<b>Fuel Tank Capacity</b>	380 GAL
<b>Max Flow</b>	2600 GPM @ 190' TDH / 82 PSI
<b>Max TDH</b>	220' TDH / 95 PSI @ 200 GPM
<b>BEP</b>	2000 GPM @ 150' TDH / 65 PSI

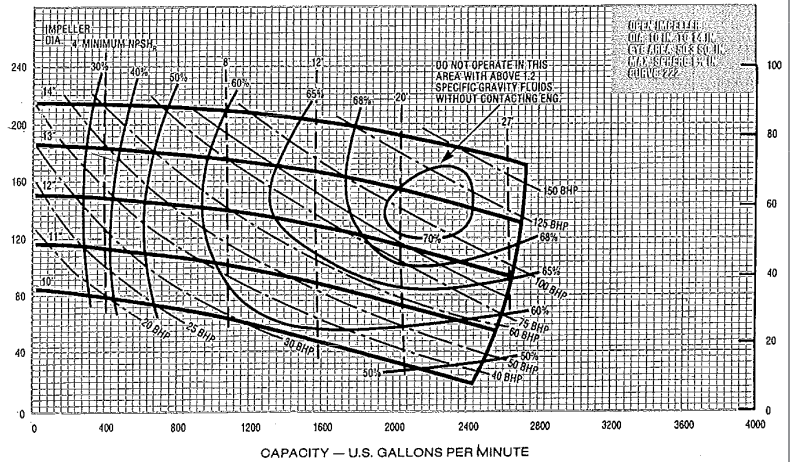

### 600 HP HIGH HEAD 8" X 6" PUMP (6822MX)

<b>Horsepower</b>	600 HP
<b>Fuel Tank Capacity</b>	180 GAL
<b>Max Flow</b>	2,800 GPM @ 630' TDH/272 PSI
<b>Max TDH</b>	658' TDH/285 PSI @ 1,000 GPM
<b>BEP</b>	2,900 GPM @ 600' TDH/260 PSI

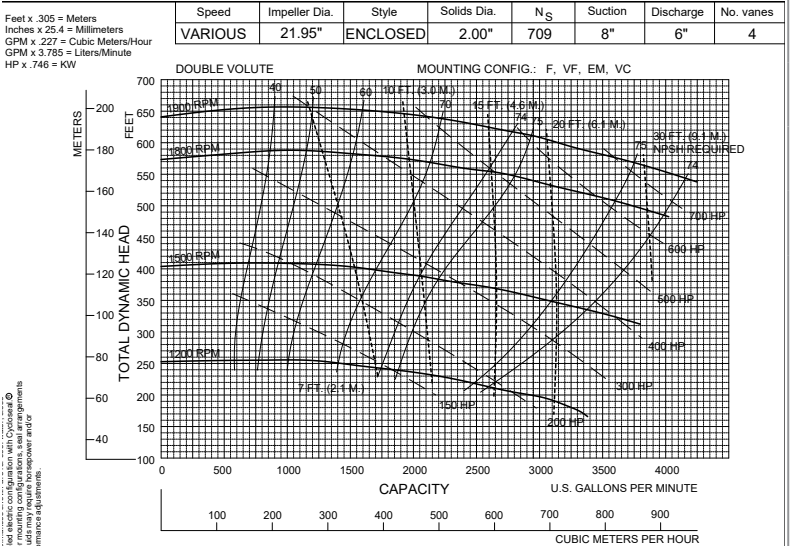

**Cornell Pump Company** • Portland, Oregon 6822MX - VARIOUS

[ PUMPS ]



## 5TUT-16 THREE FILL STAGE PUMP

<b>Horsepower</b>	425 HP
<b>Fuel Tank Capacity</b>	185 Gallons
<b>Max Flow</b>	1,400 GPM @ 720' TDH/311 PSI
<b>Max TDH</b>	924' TDH/400 PSI @ 500 GPM
<b>BEP</b>	1,200 GPM @ 800' TDH/346 PSI

\* Can Achieve Higher Flows and Pressure with Low Head Pump in Series

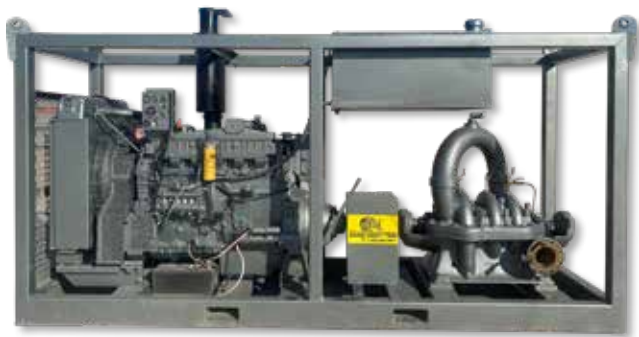

**TDH**

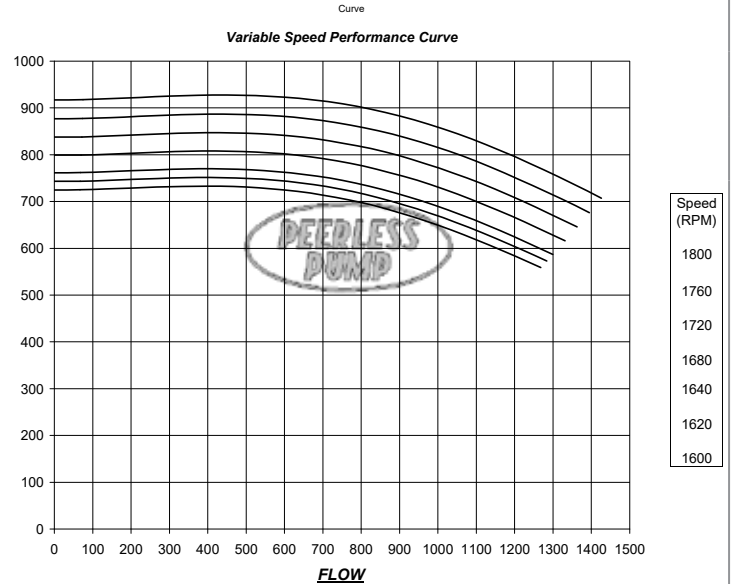

1/5/2010

5TUT16N3-US-3194-16-SpeedChange.xls

1

[ PUMPS ]

## TP5-5000 HYDROSTATIC TEST PUMP

<b>Horsepower</b>	25 HP
<b>Fuel Tank Capacity</b>	20 GAL
<b>Max Flow</b>	4.7 GPM
<b>Max Pressure</b>	5000 PSI
<b>L x W x H</b>	55.5" x 55.5" x 49"
<b>Weight</b>	??? LBS

The TP5-5000 pump is unitized with a Kubota Diesel engine.

- Cat Model 700DSG118 Triplex Pump
- .551" Plunger, .945" Stroke
- .0026 Gallons Per Stroke
- Fluid End Working Pressure 5,000 PSI Max
- Skid Mounted with 75 Gallon Water Tank
- 1/2" Suction ; 3/8" Discharge Connections
- Available with Optional Stroke Counter





## TP50-3000 HYDROSTATIC TEST PUMP

<b>Horsepower</b>	125 HP
<b>Fuel Tank Capacity</b>	30 GAL
<b>Max Flow</b>	47 GPM
<b>Max Pressure</b>	3000 PSI
<b>L x W x H</b>	18' x 8' x 9'
<b>Weight</b>	6,750 LBS



The TP50-3000 pump is unitized with a 4045 John Deere engine, 5 speed manual transmission, Giant Model GP7145 Triplex Pump

- 1.75" Plunger, 2.05" Stroke
- 063 Gallons Per Stroke
- 2 – 47 Gallons Per Minute
- Fluid End Working Pressure 3,000 PSI Max
- Trailer Mounted with 500 Gallon Water Tank
- 2" Suction; 1" Discharge Connections
- Available with Optional Stroke Counter

Trans Gear	Gear Ratio	Engine RPM	Trans Output RPM	Drive Belt Ratio	Pump Speed	GPS	GPM
5	1	2400	2400.00	3.24	740.74	0.063	46.67
5	1	850	850.00	3.24	262.35	0.063	16.53
4	1.48	2400	1621.62	3.24	500.50	0.063	31.53
4	1.48	850	574.32	3.24	177.26	0.063	11.17
3	2.45	2400	979.59	3.24	302.34	0.063	19.05
3	2.45	850	346.94	3.24	107.08	0.063	6.75
2	4.35	2400	551.72	3.24	170.29	0.063	10.73
2	4.35	850	195.40	3.24	60.31	0.063	3.80
1	8.05	2400	298.14	3.24	92.02	0.063	5.80
1	8.05	850	105.59	3.24	32.59	0.063	2.05

## W-440 HYDROSTATIC TEST PUMP

<b>Horsepower</b>	440 HP
<b>Fuel Tank Capacity</b>	100 GAL
<b>Max Flow</b>	397 GPM
<b>Max Pressures</b>	Varies depending on liners



The W-440 pump is unitized with a series 60, Tier 3 Detroit engine, 10 speed manual transmission, max flow 392 gpm with 4.5" piston.

- Pump Speed Rating - 320 Max
- Available with Piston Sizes 3", 4" and 4.5"
- Fluid End Working Pressure Rating add 5,000 psi Max
- Discharge Connection Size - 6"
- Accessory Connection Size - 2" NPT or 2" Union
- Valve Size - API #4
- Piston Rod End - API #SA-4
- Crankcase Oil Capacity - 35 gallon
- Liner Wash Capacity - 24 gallon
- Internal Gear Ratio - 4.58:1
- Length/Width/Height 20' x 3.3' x 8'
- Height - 7.8' at the Tallest Part
- 10 Speed Manual Transmission

Liner Size	GPM	GPS	Max PSI
3" Piston	14-175 GPM	.552 gps	5000 psi
4" piston	25-310 GPM	.978 gps	3100 psi
4.5" piston	32-392 GPM	1.239 GPS	2400 psi

[ PUMPS ]



# DEPENDABLE

## HIGHEST SERVICE STANDARDS QUALITY, SERVICE & URGENT RESPONSE

At Tiger Industrial, we run strict quality-control programs on all of our equipment. We meet or exceed the highest safety standards. Tiger maintains an extensive backup fleet so we are ready to respond to your every need at a moment's notice.

### GENERATORS | LIGHT TOWERS | FUEL TANKS | PRESSURE WASHERS | BLAST RATED BUILDINGS

- 25 kVA Portable Generators
- 45 kVA Portable Generators
- 85 kVA Portable Generators
- 125 kVA Portable Generators
- 150 kVA Portable Generators
- 220 kVA Portable Generators
- 300 kVA Portable Generators
- 462 kVA Portable Generators
- LED Portable Light Towers
- 528 GAL Double Wall Fuel Tanks
- Pressure Washers
- 8' x 20' Blast Rated Buildings



## OPTIONAL ACCESSORIES

- 12' X 12' Containment Berm
- 50' Extension Cord
- Auxiliary Fuel Tank
- 100 AMP Distribution Box

### 25 KVA PORTABLE GENERATOR

<b>L x W x H</b>	10' x 5' x 5'		
<b>Standby Output</b>	22 KW		
<b>Prime Output</b>	20 KW		
<b>Weight</b>	2,200 LBS		
<b>Fuel Cap</b>	42 GAL		
<b>Run Time</b>	30 HRS		
AMP DRAW		FUEL CONSUMPTION	
<b>1PH 120V</b>	55 AMPS	<b>Full Load</b>	1.65 GPH
<b>1PH 240V</b>	27 AMPS	<b>3/4 Load</b>	1.3 GPH
<b>3PH 240V</b>	60 AMPS	<b>1/2 Load</b>	0.9 GPH
<b>3PH 480V</b>	30 AMPS		



### 45 KVA PORTABLE GENERATOR

<b>L x W x H</b>	12' x 6' x 8'		
<b>Standby Output</b>	37 KW		
<b>Prime Output</b>	36 KW		
<b>Weight</b>	2,940 LBS		
<b>Fuel Cap</b>	30 GAL		
<b>Run Time</b>	22 HRS		
AMP DRAW		FUEL CONSUMPTION	
<b>1PH 120V</b>	100 AMPS	<b>Full Load</b>	3.1 GPH
<b>1PH 240V</b>	50 AMPS	<b>3/4 Load</b>	2.2 GPH
<b>3PH 240V</b>	108 AMPS	<b>1/2 Load</b>	1.6 GPH
<b>3PH 480V</b>	54 AMPS		



### 85 KVA PORTABLE GENERATOR

<b>L x W x H</b>	12' x 6' x 8'		
<b>Standby Output</b>	70 KW		
<b>Prime Output</b>	66 KW		
<b>Weight</b>	5,000 LBS		
<b>Fuel Cap</b>	127 GAL		
<b>Run Time</b>	22 HRS		
AMP DRAW		FUEL CONSUMPTION	
<b>1PH 120V</b>	188 AMPS	<b>Full Load</b>	5.5 GPH
<b>1PH 240V</b>	95 AMPS	<b>3/4 Load</b>	3.8 GPH
<b>3PH 240V</b>	204 AMPS	<b>1/2 Load</b>	2.6 GPH
<b>3PH 480V</b>	102 AMPS		



[ GENERATORS & LIGHT TOWERS ]



## 125 KVA PORTABLE GENERATOR

L x W x H		12' x 6' x 8'	
Standby Output		110 KW	
Prime Output		100 KW	
Weight		6,900 LBS	
Fuel Cap		169 GAL	
Run Time		24 HRS	
AMP DRAW		FUEL CONSUMPTION	
1PH 120V	277 AMPS	Full Load	7.3 GPH
1PH 240V	139 AMPS	3/4 Load	5.7 GPH
3PH 240V	300 AMPS	1/2 Load	4.0 GPH
3PH 480V	150 AMPS		



## 150 KVA PORTABLE GENERATOR

L x W x H		12' x 6' x 8'	
Standby Output		132 KW	
Prime Output		120 KW	
Weight		9,278 LBS	
Fuel Cap		214 GAL	
Run Time		25 HRS	
AMP DRAW		FUEL CONSUMPTION	
1PH 120V	333 AMPS	Full Load	8.4 GPH
1PH 240V	166 AMPS	3/4 Load	6.5 GPH
3PH 240V	361 AMPS	1/2 Load	4.9 GPH
3PH 480V	180 AMPS		



## 220 KVA PORTABLE GENERATOR

L x W x H		16' x 6' x 8'	
Standby Output		194 KW	
Prime Output		176 KW	
Weight		6,900 LBS	
Fuel Cap		214 GAL	
Run Time		21 HRS	
AMP DRAW		FUEL CONSUMPTION	
1PH 120V	488 AMPS	Full Load	13.6 GPH
1PH 240V	244 AMPS	3/4 Load	10.4 GPH
3PH 240V	529 AMPS	1/2 Load	7.7 GPH
3PH 480V	264 AMPS		





## 300 KVA PORTABLE GENERATOR

<b>L x W x H</b>	16' x 6' x 11'		
<b>Standby Output</b>	264 KW		
<b>Prime Output</b>	240 KW		
<b>Weight</b>	13,000 LBS		
<b>Fuel Cap</b>	300 GAL		
<b>Run Time</b>	21 HRS		
<b>AMP DRAW</b>		<b>FUEL CONSUMPTION</b>	
<b>1PH 120V</b>	667 AMPS	<b>Full Load</b>	15 GPH
<b>1PH 240V</b>	333 AMPS	<b>3/4 Load</b>	14 GPH
<b>3PH 240V</b>	722 AMPS	<b>1/2 Load</b>	11 GPH
<b>3PH 480V</b>	361 AMPS		



## 4,000 WATT PORTABLE LIGHT TOWER

<b>L x W x H</b>	173" x 50" x 70"
<b>Max Height</b>	32'
<b>Weight</b>	1,644 LBS
<b>Fuel Cap</b>	30 GAL
<b>Run Time</b>	48 HR
<b>Lumens</b>	440,000
<b>Light Coverage</b>	5-7 Acres
<b>Sound Level</b>	66 DB



## LED PORTABLE LIGHT TOWER

<b>L x W x H</b>	716" x 98" x 348"
<b>Weight</b>	1,720 LBS
<b>Fuel Cap</b>	30 GAL
<b>Run Time</b>	50 HR
<b>Lumens</b>	542,000
<b>Stabilizer</b>	Four-Point Outrigger System

- SHO-HD® Lamp Fixture – 4 Metal Halide Lamps Only
- SLS™ Sequenced Light System™
- Gull-Wing Style Doors – Reaction injection molded doors providing strength and corrosion resistance
- Forklift Pockets and Lifting Eye
- 30 Gallon Polyethylene Fuel Tank
- Four-Point Outrigger System
- GPS Ready
- 59° Fixture Rotation
- 55 MPH Operating Wind Speed Rating



[ GENERATORS & LIGHT TOWERS ]



# PRESSURE WASHERS & FUEL TANKS

[ PRESSURE WASHERS & FUEL TANKS ]

## TRAILER MOUNT HOT WATER PRESSURE WASHER OPTIONAL ACCESSORIES

- Turbo Nozzle
- 3/8" x 50' Pressure Hose
- Foot Pedal
- Flex Lance
- Double Trigger Gun
- Extension Wand
- 30" Hydro Mower

### 4,000 PSI TRAILER MOUNT HOT WATER PRESSURE WASHER

<b>Skid Mount L x W x H</b>	54" x 48" x 50"
<b>Trailer Mount LxWxH</b>	19' x 8' x 6'
<b>Weight</b>	6,500 LBS
<b>Fuel Capacity</b>	18 GAL
<b>Water Capacity</b>	325 GAL
<b>Run Time</b>	4 HRS
<b>Temperature</b>	160° Fahrenheit
<b>Trailer Ball</b>	2" OR 2 5/16"
<b>GPM</b>	6 GPM
<b>Engine</b>	25 HP Kubota Diesel



### 4,000 PSI TRAILER MOUNT HOT WATER PRESSURE WASHER 2-SKID (DOUBLE TROUBLE)

<b>Skid Mount L x W x H</b>	54" x 48" x 50"
<b>Trailer Mnt L x W x H</b>	19' x 8' x 6'
<b>Weight</b>	8,000 LBS
<b>Fuel Capacity</b>	36 GAL
<b>Water Capacity</b>	325 GAL
<b>Run Time</b>	4 HRS
<b>Temperature</b>	160° Fahrenheit
<b>Trailer Ball</b>	2" OR 2 5/16"
<b>GPM</b>	6 GPM
<b>Engine</b>	25 HP Kubota Diesel



### 528 GALLON DOUBLE WALL FUEL POD

<b>L x W x H</b>	87" x 46" x 52"
<b>Containment</b>	110% Secondary Containment
<b>Capacity</b>	1,825 LBS Empty/5,574 LBS Full

- Internal Baffles
- Secure Hose Access
- Full Load Lifting Eyes
- Tie Down Points
- Direct to Machinery Fuel Ports

#### OPTIONAL ACCESSORIES

- 16' Tandem Trailer
- 110V Fuel Pump
- Fuel Pump - 12V Fuel Pump & Solar Panel



# 8' X 20' BLAST RESISTANT BUILDINGS



INFRASTRUCTURE

Tiger has portable buildings that are used for pipeline inner connections at the plant where they require blast rated models. If you need a blast resistant building, we've got it!

## 8' X 20' BLAST RESISTANT BUILDING/COOL DOWN BUILDING

SIZE	PSI RATING	DURATION	RESPONSE LEVEL
8' x 20' x 8'6"	6.3 PSI	800 MS	MEDIUM
8' x 20' x 8'6"	8.0 PSI	42.5 MS	MEDIUM
<b>Weight</b>	12000 LBS		
<b>Lifting Lugs</b>	(4)		
<b>HVAC</b>	(1) HVAC - Unit, Non-Classified Electrical Insulated		
<b>Electrical</b>	(1) 240 V, 100 A, Single Phase, Non-Classified Electrical		
<b>Doors/Windows *</b>	<b>(2) Blast Rated Doors/ (1) Blast Rated Windows</b>		
<b>Fire Protection</b>	(2) Smoke Detectors & (1) Fire Extinguisher		
<b>Lights</b>	(2) Emergency Exit Lights & (3) 4' Long Dual Bulb Fluorescent Lights		
<b>Outlets/Ports</b>	(3) Duplex Electrical Outlets/ (2) Data Ports & (2) Phone Ports		
<b>Walls</b>	Painted Interior Wall Covering - Plywood		
<b>Floors *</b>	<b>Heavy Industrial Rubberized Tile Floors</b>		
<b>Paint</b>	Exterior Paint - Direct To Metal, Rust Inhibiting, High Solids Urethane (Steel Grit Blast Prep)		

\* UPGRADE INCLUDED



[ BLAST RESISTANT BUILDINGS ]



# WE RENT RELIABILITY

SOME SAY IT'S OUR EQUIPMENT, OTHERS SAY IT'S OUR PEOPLE! TRUTH IS, RENTAL EQUIPMENT PERFORMS NOT SOLELY BECAUSE IT'S BUILT RIGHT, BUT BECAUSE IT'S MAINTAINED RIGHT.

**PUMPS | GENERATORS | MATTING | BLAST RESISTANT BUILDINGS | HP CLEANING EQUIPMENT**

#### **BATON ROUGE, LA**

35269 Carson Drive  
Geismar, LA 70734

#### **SULPHUR, LA**

3334 Carbide Drive  
Sulphur, LA 70665

#### **BEAUMONT, TX**

1313 Gulf Street  
Beaumont, TX 77701

#### **HOUSTON, TX**

12803 Highway 225  
La Porte, TX 77571

#### **VICTORIA, TX**

11901 US Highway 59 North  
Victoria, TX 77905

#### **DILLEY, TX**

12350 S IH 35  
Dilley, TX 78017

#### **MIDLAND, TX**

7701 West Industrial  
Midland, TX 79706

Tel: 1-409-832-9336 | 24/7: 1-888-866-0047  
[TigerIndustrialRentals.com](http://TigerIndustrialRentals.com)